

# TILTING DRUM RING - TDR-55

APPROX WEIGHT: 19.45 lbs.  
DOES NOT INCLUDE WEIGHT OF POWER OR PACKAGING!!!

\*\*\* ANY ADDITIONS, DELETIONS, OR OMISSIONS MUST BE CORRECTED ON THIS DRAWING AS THIS DRAWING WILL BE CONSIDERED ALL INCLUSIVE \*\*\*  
ALL GRAPHICS PROVIDED ARE FOR REFERENCE ONLY. IF CERTAIN DIMENSIONS ARE CRITICAL PLEASE VERIFY THOSE DIMENSIONS WITH YOUR SALESPERSON

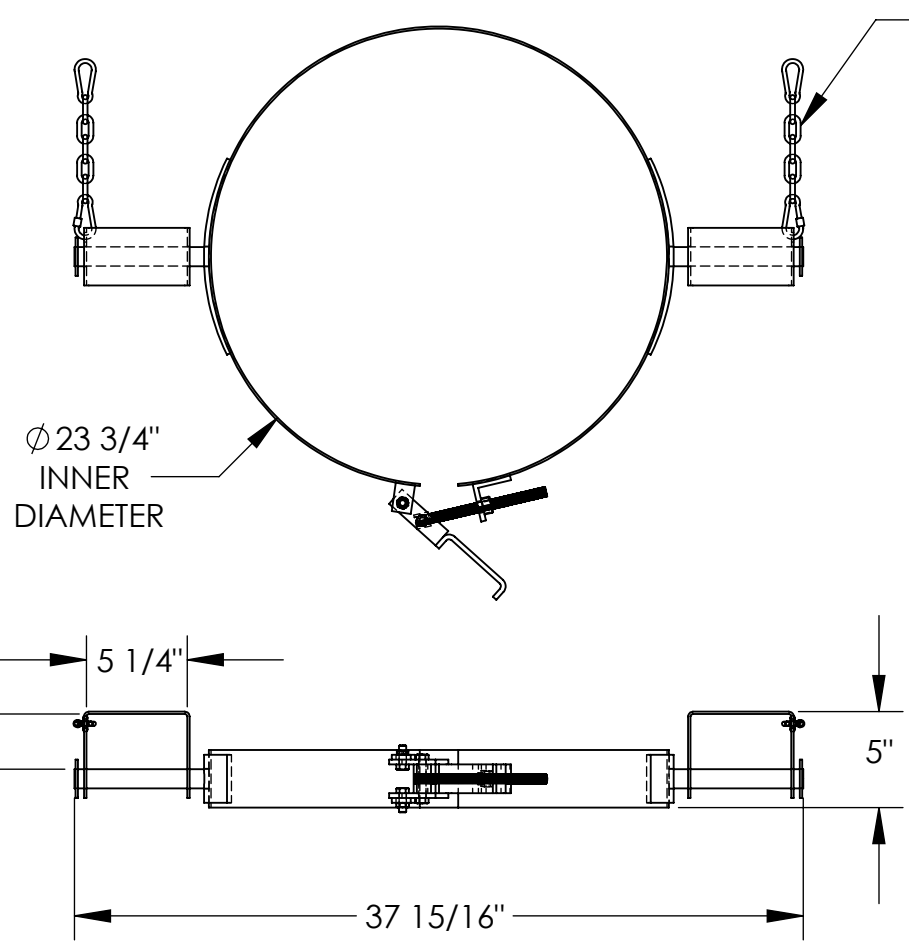

NOTE: FULL LENGTH OF CHAINS NOT SHOWN

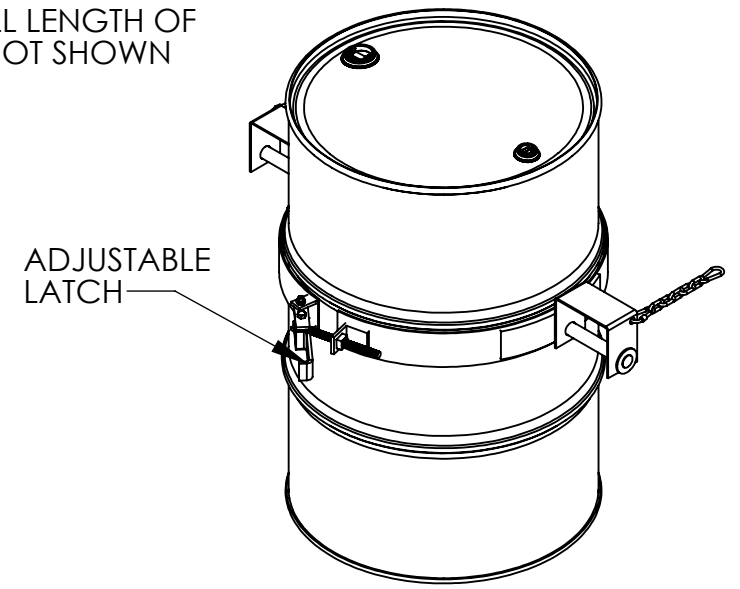

DRUM SHOWN FOR REFERENCE ONLY;  
DRUM CAN BE PURCHASED SEPARATELY

DIMENSION TOLERANCE  $\pm 1/4$ "

**APPROVAL**

I, THE UNDERSIGNED, AGREE THAT THE PRODUCT AS REPRESENTED SATISFIES DESIGN AND DIMENSION REQUIREMENTS. I ALSO ACKNOWLEDGE MY DUTY TO CONFIRM PRODUCT AND INSTALLATION COMPLIANCE WITH ALL APPLICABLE FEDERAL, STATE AND LOCAL REGULATIONS AND STANDARDS.

**ANY MODIFIED UNITS ARE NON-RETURNABLE**

[ ] As drawn [ ] As marked

Signed: \_\_\_\_\_ Date: \_\_\_\_\_

Printed Name: \_\_\_\_\_

LEAD TIME WILL START UPON RECEIPT OF SIGNED APPROVAL DRAWING

DISTRIBUTOR'S NAME:		P.O.#
HOF EQUIPMENT COMPANY		X
PH: 888-990-1150		W.O.#
DRAWN BY: ND		X
DATE: 01/20/06		SALES: X
REFERENCE: X	SCALE: 1:10	FILE NAME:
QUOTED LEAD TIME: X	QUOTE #	09-007-095
	X	

## STANDARD FEATURES

- MODEL NUMBER: TDR-55
- CAPACITY: 1,200 LBS.
- OVERALL WIDTH:  $37 \frac{15}{16}$ "
- INNER DIAMETER:  $\text{Ø} 23 \frac{3}{4}$ "
- OVERALL HEIGHT: 5"
- FORK OPENING :  $5 \frac{1}{4}$ "W x  $2 \frac{7}{8}$ "H
- INCLUDES (2) 42"L CHAINS
- FOR USE WITH 55 GALLON DRUMS
- TOUGH BAKED IN POWDERCOAT BLUE FINISH

## SPECIAL FEATURES

NONE

FOR INTERNAL USE ONLY PROJECT SIGN OFF	
SALES	
ENG.	
FAB.	
POWER	