

2-SHELF STOCKPICKER TRUCK - SPA2-2840

APPROX WEIGHT: 89.00 lbs.
DOES NOT INCLUDE WEIGHT OF POWER OR PACKAGING!!!

*** ANY ADDITIONS, DELETIONS, OR OMISSIONS MUST BE CORRECTED ON THIS DRAWING AS THIS DRAWING WILL BE CONSIDERED ALL INCLUSIVE ***

ALL GRAPHICS PROVIDED ARE FOR REFERENCE ONLY. IF CERTAIN DIMENSIONS ARE CRITICAL PLEASE VERIFY THOSE DIMENSIONS WITH YOUR SALESPERSON

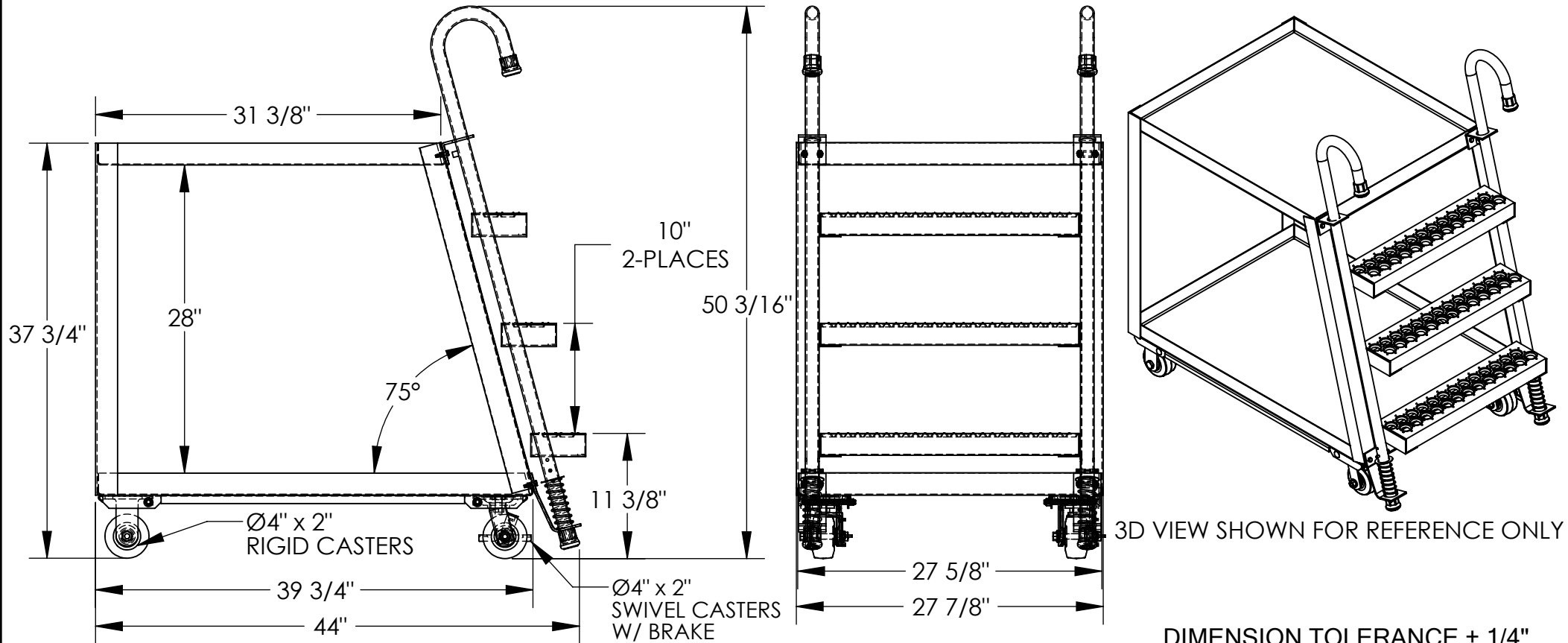

3D VIEW SHOWN FOR REFERENCE ONLY

DIMENSION TOLERANCE ± 1/4"

STANDARD FEATURES

- MODEL NUMBER IS SPA2-2840
- CAPACITY: 660 LBS. TOTAL
(330 LBS. PER SHELF)
- OVERALL WIDTH IS 27 7/8"
- OVERALL LENGTH IS 44"
- OVERALL HEIGHT IS 50 3/16"
- BOTTOM SHELF SIZE: 27 5/8" X 39 3/4"
- TOP SHELF SIZE: 27 5/8" X 31 3/8"
- TOP SHELF HEIGHT: 37 3/4"
- SHELF CLEARANCE: 28"
- (2) 4X2 MOLD-ON-RUBBER SWIVEL CASTER WITH BRAKE
- (2) 4x2 MOLD-ON-RUBBER RIGID CASTER ALUMINUM FRAME CONSTRUCTION
- STEEL LADDER WITH TOUGH BAKED IN POWDER COATED SILVER FINISH
- LADDER CAPACITY IS 350 LBS

SPECIAL FEATURES

NONE

A P P R O V A L	I, THE UNDERSIGNED, AGREE THAT THE PRODUCT AS REPRESENTED SATISFIES DESIGN AND DIMENSION REQUIREMENTS. I ALSO ACKNOWLEDGE MY DUTY TO CONFIRM PRODUCT AND INSTALLATION COMPLIANCE WITH ALL APPLICABLE FEDERAL, STATE AND LOCAL REGULATIONS AND STANDARDS.	
	ANY MODIFIED UNITS ARE NON-RETURNABLE	
	[] As drawn	[] As marked
	Signed: _____ Date: _____	
Printed Name: _____		
LEAD TIME WILL START UPON RECEIPT OF SIGNED APPROVAL DRAWING		

FOR INTERNAL USE ONLY PROJECT SIGN OFF	
SALES	
ENG.	
FAB.	
POWER	

DISTRIBUTOR'S NAME:		P.O.#
HOF EQUIPMENT COMPANY		W.O.#
PH: 888-990-1150		SALES:
DRAWN BY: ND	DATE: 8/31/05	FILE NAME:
REFERENCE:	SCALE: 1:13	32-007-008
QUOTED LEAD TIME:	QUOTE #	