

MANUAL TRASH COMPACTOR - MTC-30

APPROX WEIGHT: 157.80 lbs.
DOES NOT INCLUDE WEIGHT OF POWER OR PACKAGING!!!

*** ANY ADDITIONS, DELETIONS, OR OMISSIONS MUST BE CORRECTED ON THIS DRAWING AS THIS DRAWING WILL BE CONSIDERED ALL INCLUSIVE ***

ALL GRAPHICS PROVIDED ARE FOR REFERENCE ONLY. IF CERTAIN DIMENSIONS ARE CRITICAL PLEASE VERIFY THOSE DIMENSIONS WITH YOUR SALESPERSON

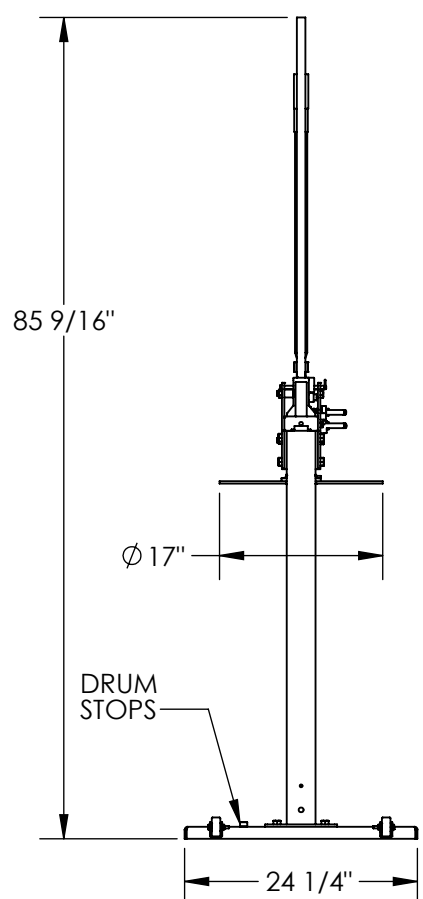

STANDARD FEATURES

- MODEL NUMBER: MTC-30
- OVERALL WIDTH: 32 1/16"
- USABLE WIDTH: 25 3/8"
- OVERALL LENGTH: 24 1/4"
- USABLE LENGTH: 24 1/4"
- OVERALL HEIGHT: 85 9/16"
- SERVICE RANGE: 1 1/4" TO 35 3/4"
- COMPACTOR HEAD: 17"
- 7,000 LBS OF COMPACTING FORCE
- WHEELS: RUBBER - 2"
- TOUGH BAKED IN POWDER COATED BLUE FINISH
- DRUM USED: 30 GALLON

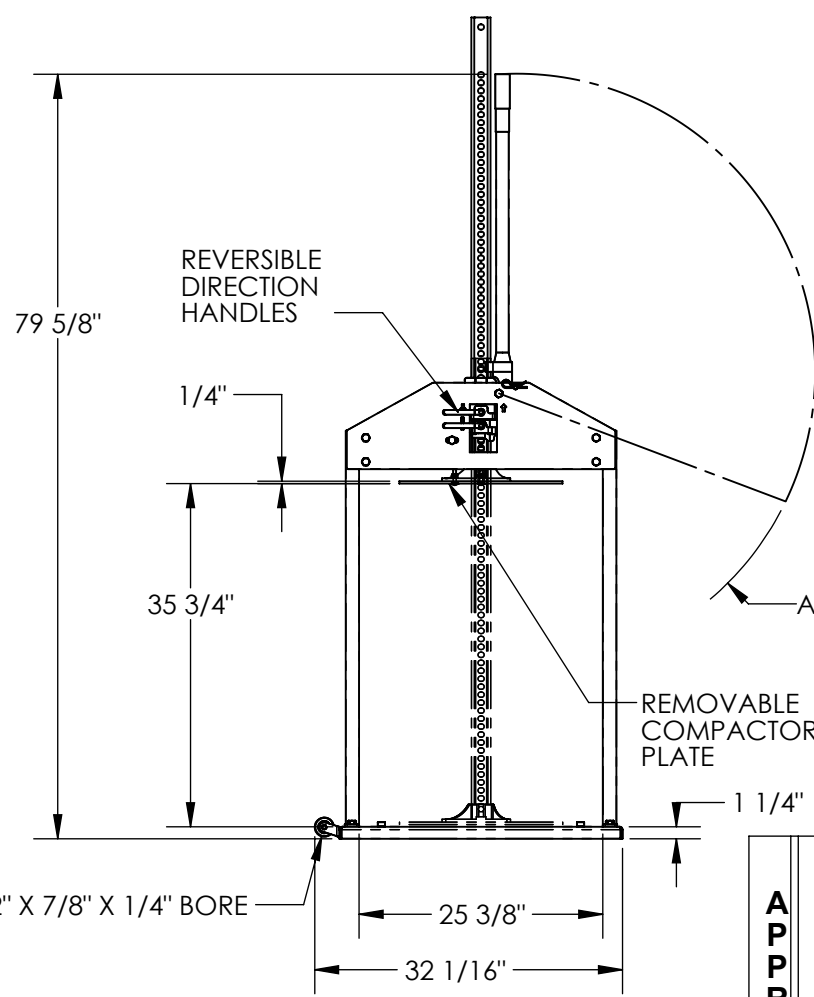

SPECIAL FEATURES

NONE

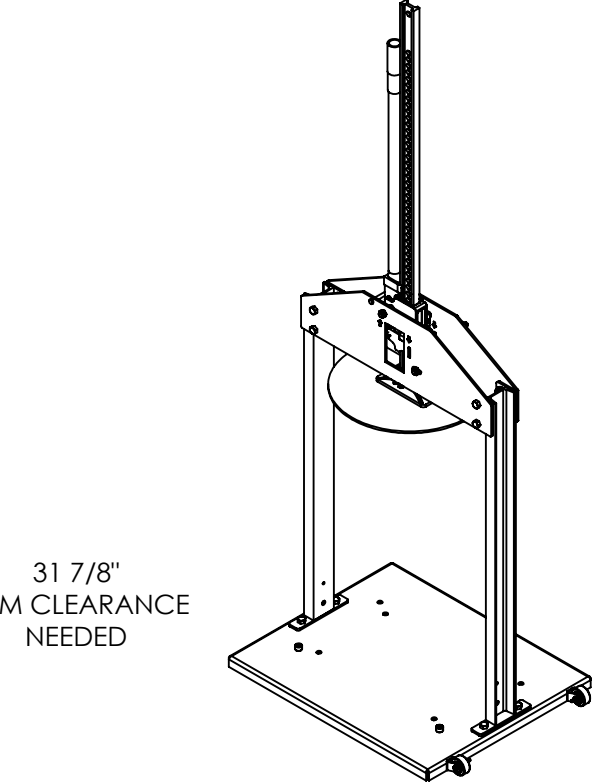

APPROVAL

I, THE UNDERSIGNED, AGREE THAT THE PRODUCT AS REPRESENTED SATISFIES DESIGN AND DIMENSION REQUIREMENTS. I ALSO ACKNOWLEDGE MY DUTY TO CONFIRM PRODUCT AND INSTALLATION COMPLIANCE WITH ALL APPLICABLE FEDERAL, STATE AND LOCAL REGULATIONS AND STANDARDS.
UNITS REQUIRING APPROVAL DRAWINGS OR MODIFIED ARE NON-RETURNABLE
[] As drawn [] As marked

Signed: _____ Date: _____

Printed Name: _____

LEAD TIME WILL START UPON RECEIPT OF SIGNED APPROVAL DRAWING

| | |
|---|--|
| FOR INTERNAL USE ONLY PROJECT SIGN OFF | |
| SALES | |
| ENG. | |
| FAB. | |
| POWER | |

| | | | | |
|---------------------|----|-----------------------|------------|------------|
| DISTRIBUTOR'S NAME: | | HOF EQUIPMENT COMPANY | | P.O.# |
| | | PH: 888-990-1150 | | W.O.# |
| DRAWN BY: | WS | DATE: | 02/03/2009 | SALES: X |
| REFERENCE: | X | SCALE: | 1:20 | FILE NAME: |
| QUOTED LEAD TIME: | X | QUOTE # | X | 22-007-008 |